

DELTA® protects property. Saves energy. Creates comfort.

## TECHNICAL DATA SHEET

### DELTA®-MS CLEAR

**Foundation Dampproofing and Wall Waterproofing for Insulating Concrete Forms.**

#### MATERIAL

DELTA®-MS CLEAR is an extruded and vacuum formed membrane made from a special high-density polyethylene (HDPE). A highly effective additive package stabilizes and protects it against oxidation and UV damage. This translucent membrane is tough, durable, and unaffected by acidic soils or elevated alkalinity (concrete). DELTA®-MS CLEAR provides high compressive strength, impact resistance, and chemical and environmental stress crack resistance.

#### PROPERTIES

DELTA®-MS CLEAR is a dimpled membrane, impermeable to water and water vapor. The dimple pattern creates an air-gap between the membrane and the foundation wall. This allows any incidental water getting past the dimpled membrane to flow freely to the perimeter footing drain. The air-gap provides a safe separation and full capillary break between the foundation wall and any ground moisture. The unique translucent dimple sheet has been specifically designed for Insulating Concrete Form (ICF) foundations. ICF systems have to contend with many seams that could potentially allow water intrusion. DELTA®-MS CLEAR bridges all these seams and creates an air-gap that separates any soil moisture from the wall. The high compressive strength of the membrane ensures sustainable protection of foundation walls up to 12 ft below grade.

#### APPLICATION

DELTA®-MS CLEAR is installed by unrolling the membrane against the ICF foundation wall. DELTA® Accessories allow for quick and effective fastening of the membrane. The membrane is translucent to allow the applicator to see attachment strips or grade marks for easier application. The top edge of the product is sealed and protected against intrusion of soil particles and surface water with sealant and specifically designed profiles and fasteners.

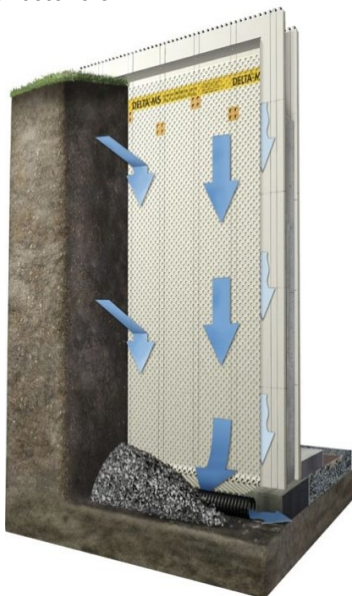

## Technical Data

Product name	DELTA®-MS CLEAR	
Color	clear / translucent	
Material	Special virgin high-density polyethylene (stabilized)	
Dimple height	5/16" (8 mm)	ASTM D6364-06
Compressive strength	approx. 5,200 psf (250 kN/m <sup>2</sup> )	ASTM D6364-06
Flow rate / unit width @ hydr. grad. 1; 100 kPa	10.6 gal/min/ft (132 l/min/m)	ASTM D4716-08
Flow rate / unit width @ hydr. grad. 0.1; 100 kPa	3 gal/min/ft (37.5 l/min/m)	ASTM D4716-08
Air-gap volume between dimples	apprx. 0.13 gal/ft <sup>2</sup> (5.3 l/m <sup>2</sup> )	ASTM D4716-08
Water penetration resistance	> 120 psi (815 kPa) Watertight	AATCC 127-1995
Water vapor transmission	< 22 ng/(Pa s m <sup>2</sup> )	ASTM E96, Meth. A
Vapor permeance	< 0.3 perms [grains/h/ft <sup>2</sup> /in Hg]	ASTM E96, Meth. A
Temperature range	-22°F to +176°F (-30°C to +80°C)	ASTM D5261-92
Chemical properties	Excellent chemical resistance, resistant to root-penetration, rot-proof	
Toxicity	non-toxic, non-polluting	
Weight per unit area	approx. 17.1 oz/yd <sup>2</sup> (580 g/m <sup>2</sup> )	ASTM D5261-92 (2003)
Roll dimensions / weight	6' 7" (2 m) 51 lbs (23.1 kg) 8' (2.45 m) 63 lbs (28.6 kg)	
Service life expectancy	> 25 years (at pH between 4 and 9, and temperature below 77°F / 25°C 25°C). Do not expose to UV light for more than 30 days.	
DELTA® Accessories	DELTA®-MOLD STRIP DELTA®-FAST'ner	

DELTA® products support sustainable and energy-efficient building practices, including efforts toward achieving LEED® certification (LEED® for New Construction & Major Renovations, LEED® for Core and Shell, LEED® for Existing Buildings and LEED® for Homes).

For technical support, call our technical support team at 1-888-4DELTA4 (1-888-433-5824) extension 326, or visit [www.cosella-dorken.com](http://www.cosella-dorken.com).

ICC-ESR-2303 Dampproofing & Wall Waterproofing Membrane  
CCMC # 13197 Drainage Layer  
CCMC # 13164 Dampproofing

Cosella-Dörken Products Inc. 4655 Delta Way Beamsville, Ontario L0R 1B4

1-888-4 DELTA 4, (905) 563-3255 Fax: (905) 563-5582

info@cosella-dorken.com, www.cosella-dorken.com

A company of the Dörken Group