

DELTA<sup>®</sup> protects property. Saves energy. Creates comfort.

PREMIUM QUALITY

# DELTA<sup>®</sup>-GEO-DRAIN

//// //// //// //// *Quattro*

## A new dimension of safety for thick waterproof coatings.

The first compact four-layer drainage sheet on the market.

Patent-protected.



■ Protection and drainage system

■ For thick waterproof coatings

■ For vertical application in building construction

**Double drainage  
at a stroke?**

**DELTA® means perfect  
foundation protection!**



■ **DELTA®-GEO-DRAIN Quattro**

This unique protection and drainage system offers maximum safety for thick viscoplastic coatings. This holds true even if driving rain is able to penetrate through an imperfectly installed upper edge trim.

In an absolutely watertight system, such rain-water would exert hydrostatic pressure on the waterproof coating. However, the micro-perforated slip film which, together with the additional filter cloth, acts as a backup drainage layer behind the dimpled sheet ensures that any water is drained off safely. In addition, the slip film prevents the transmission of movement to the waterproof coating.

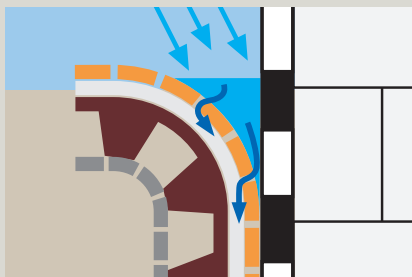

**DELTA®-Accessories**

Why not use the advantages of the comprehensive range of DELTA®-Accessories: DELTA®-GEO-DRAIN CLIP, DELTA®-NOPPENBAHNEN-PROFIL, DELTA®-HAFTNAGEL and DELTA®-MS DÜBEL.

DELTA®-Quality branded products  
made by Dörken.

**For draining off water before it reaches the  
waterproof coating:**

# DELTA®-GEO-DRAIN

## High compressive strength. Amp

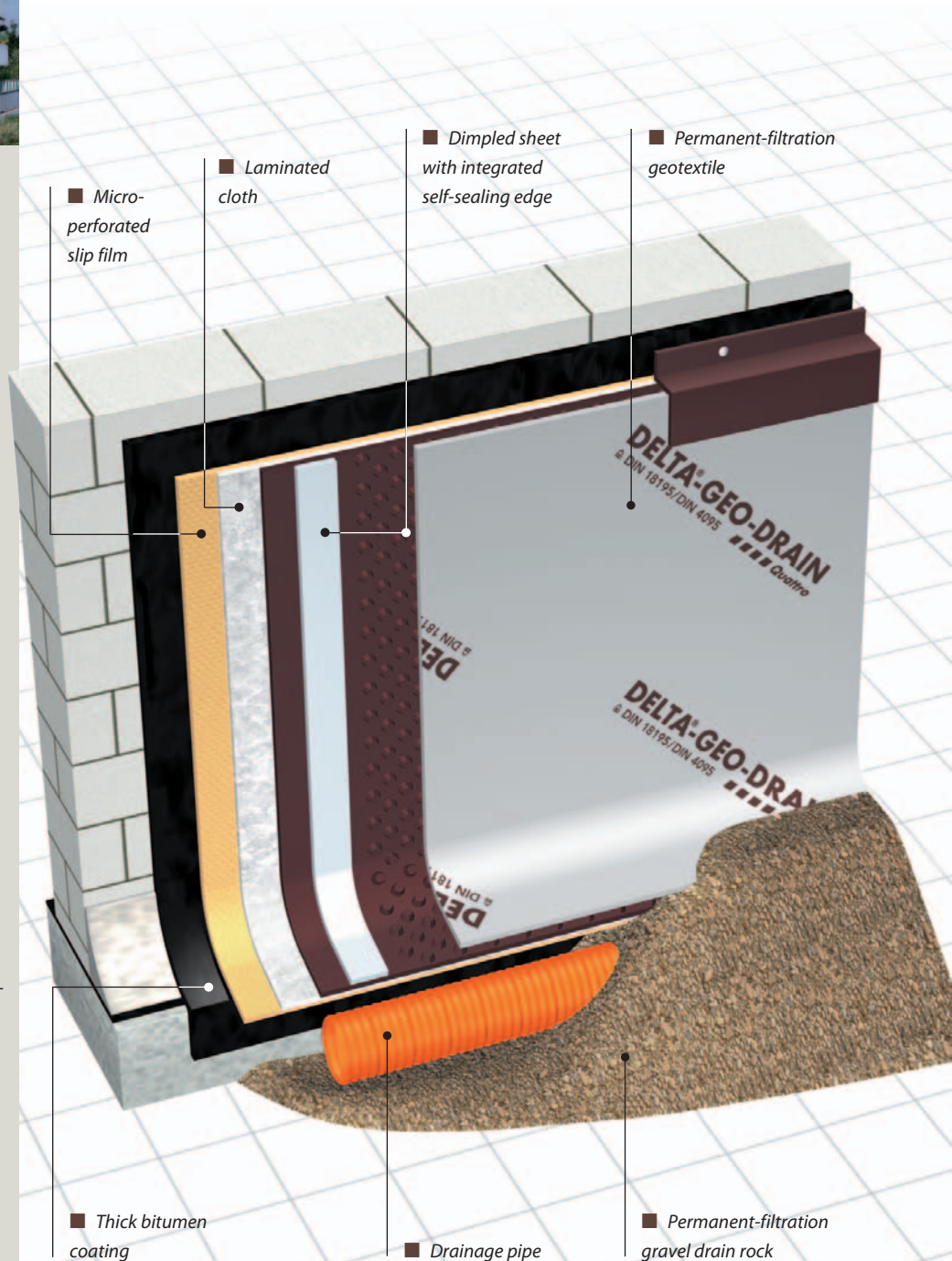

PREMIUM QUALITY

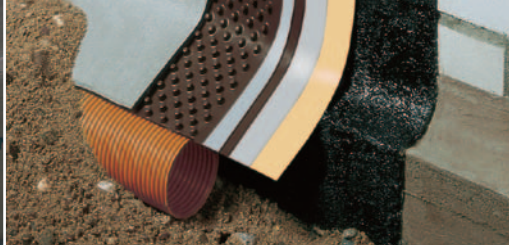

DELTA®-NOPPENBAHNEN-PROFIL with DELTA®-GEO-DRAIN CLIP.

Sheets end on top of the drain pipe.

Integrated self-adhesive border for precise installation.

# N Quattro

## ple safety margin. Easy application.

### DELTA®-GEO-DRAIN Quattro ...

- ... being a four-ply material, is a compact unit that can be applied swiftly straight off the roll without any need for special grade backfill.
- ... keeps water from accumulating between the thick coating and the slip film, effectively preventing the buildup of water pressure on the waterproof coating.
- ... features ample safety margins for sheet movements as well as improved slip performance.
- ... offers high resistance to compression thanks to its special dimple design.
- ... incorporates an additional damping membrane.
- ... dependably drains off any seepage, surface water, and wall runoff.
- ... features outstanding drainage capacity for handling unusually large quantities of water.
- ... complies with the requirements of DIN 18195, DIN 4095, and the "Guideline for Planning and Executing Thick Waterproof Coatings".
- ... effectively drains off methane and radon gas.
- ... is absolutely rot-proof thanks to its material additives.
- ... is patent-protected.
- ... can be installed at depths of up to 10 m.



DELTA®-GEO-DRAIN Quattro – a compact unit that can be swiftly installed in one go.



## Why not profit from the DELTA®-System?

### Layer one: Micro-perforated slip film.

This sheet distributes permanent soil pressure. Its micro-perforation allows any water penetrating between the waterproofing and the slip film to escape into the laminated drainage layer.

### Layer two: Laminated cloth.

This cloth absorbs impacts and serves as a backup drainage layer. Even water coming in through an

imperfectly mounted edge-sealing strip will be safely drained off.

### Layer three: Dimpled sheet with self-adhesive border.

The dimples that face towards the soil create a maximum-capacity drainage layer that covers the entire surface.

### Layer four: Permanent-filtration geotextile.

Fused to the dimpled sheet, this filter cloth reliably keeps the dimple structure from clogging up.

Needless to say, we have a range of perfect accessories, of which you find additional information on the next page.

# DELTA®-GEO-DRAIN Quattro

## Technical Data Overview:

Dimpled sheet material	HDPE
Geotextile material	Polypropylene
Dimple height	approx. 9 mm
Compressive strength	approx. 400 kN/m <sup>2</sup>
Air gap between dimples	approx. 7.7 l/m <sup>2</sup>
Service temperature range	- 30 °C to + 80 °C
Roll size	12.5 m x 2 m
Geo-composite for application in drainage systems	D + F
Tensile strength	MD 6 kN/m/CMD 6 kN/m (EN 10319)
Dynamic perforation	40 mm (EN 918)
Characteristic opening size	150 µm (EN ISO 12956)
Water permeability	8 · 10 <sup>-2</sup> m/s (EN ISO 11058)
Water flow capacity in the plane	3.1 · 10 <sup>-3</sup> m <sup>2</sup> /s (EN ISO 12958) at 20 kN/m <sup>2</sup>
Durability	To be covered within two weeks after installation. Will endure for 25 years in natural soil having a pH value between 4 and 9 at a soil temperature of 25 °C max.

# DELTA®-Accessories for DELTA®-GEO-DRAIN Quattro.

**Dörken makes your life easier – systematically.**

This is why you are sure to appreciate these handy DELTA®-Accessories:



**DELTA®-NOPPEN-BAHNEN-PROFIL**  
Edge sealing strip.

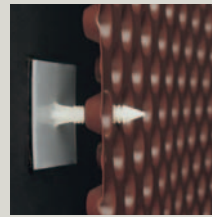

**DELTA®-HAFTNAGEL**  
Self-adhesive pin aids installation.

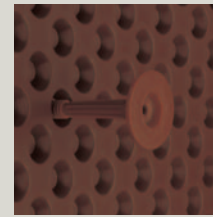

**DELTA®-MS DÜBEL**  
Plastic wall plug for sheet attachment.



**DELTA®-GEO-DRAIN CLIP**  
Installation clip for swift and easy fastening.

DELTA® is a registered trademark of Ewald Dörken AG, Herdecke.

# DELTA®



*DELTA®-System ...*

**... for owners:**

"... What I get is a mature problem solution provided at a fair price by the top specialist in quality branded products!"

**... for workers:**

"... What I get is a complete system made by a single manufacturer that enables me to do anything to the owner's entire satisfaction. There is no safer way!"

**... for planners:**

"... I can be certain that both innovative and standard products will be used in implementing my roof and cellar plans in a systematic and forward-looking way."

**DÖRKEN**  
Dörken GmbH & Co. KG  
Wetterstraße 58  
D-58313 Herdecke  
Tel.: +49 23 30/63-0  
Fax: +49 23 30/63-355  
bvf@doerken.de  
www.doerken.de

 **A company of the Dörken Group**

■ **Standard requests for tender as well as detailed installation instructions for all DELTA®-Products may be obtained at [www.doerken.com](http://www.doerken.com) as pdf files for you to print out and save.**